

# The Phnom Penh Post

Fri Sep 07 2018 12:38:15 GMT+0800 (Malaysia Time)

## Apennines Condominium equips the first-ever car elevator in Cambodia

**Sponsored** | Publication date 08 October 2015 | 09:22 ICT

Share f t

Aimed to provide high quality construction, convenience and comfortable living, the owner of the Apennines Condominium project has designed a 17-storey building over 600 square metres of land. In addition, the development has included a car elevator that smoothly lifts a vehicle to one of their six-floor parking spaces. This is the first development in Cambodia that will be equipped with such a luxury, large-scale elevator that can handle anything from a small compact sedan to a large SUV.

Soth Socheata, Administrative Executive of Apennines said the project is being built with international standards and that the structure has a unique artisanal design that makes it universal luxury condominium.

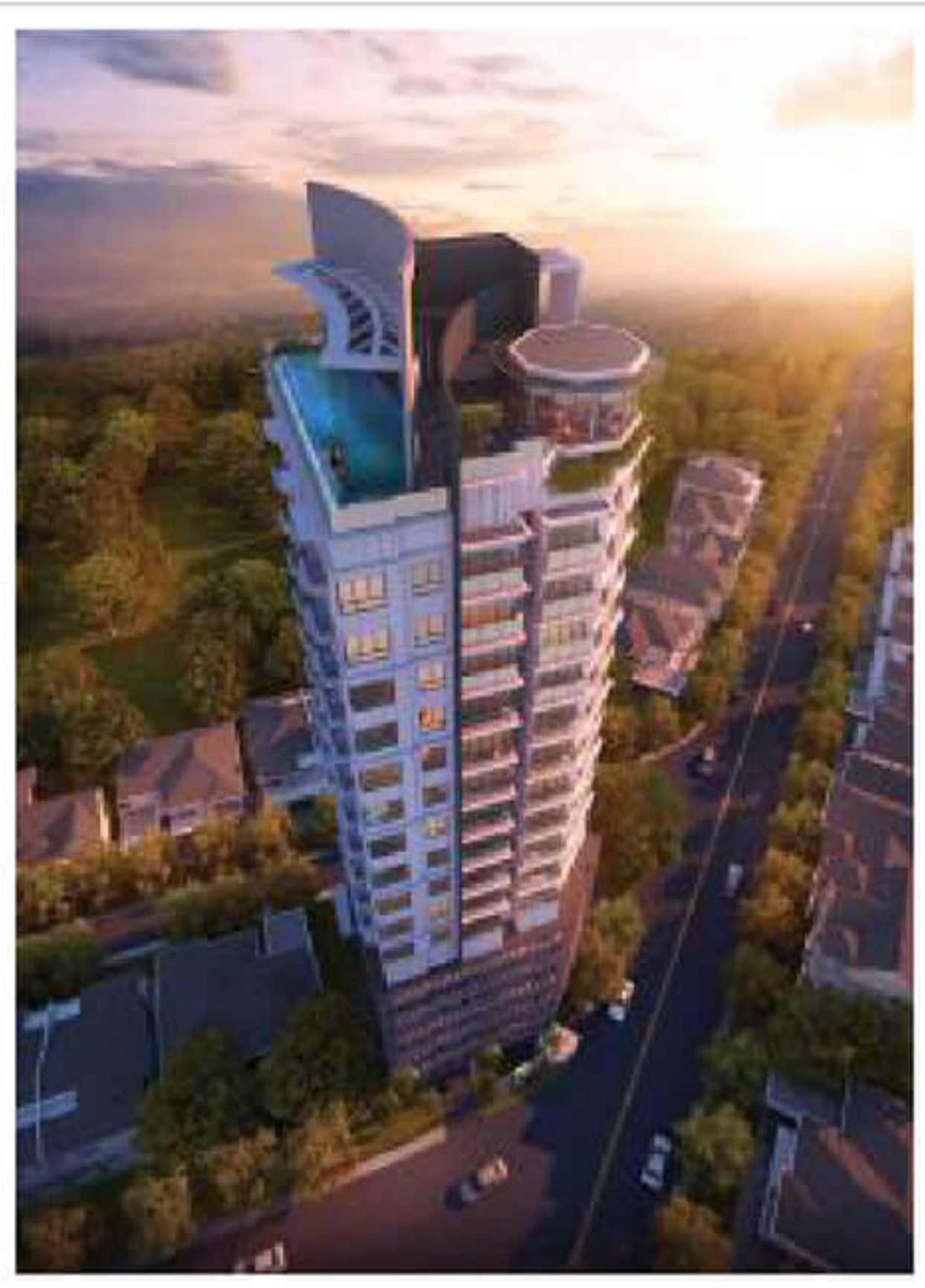

The Apennines condominium project is developed by KHSI Investment PTE LTD, a Singaporean company, who has completed an array of successful projects in Singapore and Malaysia. Designed by a talented group of Singaporean designers and Malaysian architects, the development is focused on comfort, functionality and the aesthetics of modern life.

Socheata added that the team behind the project has won various awards in their own countries.

“In our design, the group has placed the pillars at the corner of the wall, making the building more spacious, especially the six-floor parking space,” she said. “So after drivers leave the elevator, they don’t have to worry about any obstructions.”

She added that in each condo unit, the bedroom, living room and kitchen are all large and wide, with private balconies that give a great view of Phnom Penh.

The 43 unit project is divided into four types of units. Unit Type A has two bedrooms, a living room and a kitchen, totaling 66 square metres; Unit Type B has three bedrooms, a living room and a kitchen at 105 square metres; Unit Type C has one bedroom, a living room and a kitchen with its square metre at 46 square metres; and Type D has two bedrooms, a living room and a kitchen at 83 square metres.

In addition, the condominiums have an array of additional facilities.

“A gym for general exercise and a swimming pool is located on the top floor of the Apennines condominium,” she said, adding that it is a great place to take photos of Phnom Penh and get fresh air.

The Apennines condominium project is underway with 100 per cent of the foundation has been completed and the continued construction of the upper-ground floor, scheduled to be completed in the next 24 months. The project is location in Toul Kork, about 300 metres from the Royal University of Phnom Penh, near Pannasastra University, as well as other private schools and supermarkets, such as TK Avenue, Parksons and the new Aeon mall.

For further information, please contact: 023 890 489 / 097 384 1177 / 097 384 1188, Email: [khsi.development@gmail.com](mailto:khsi.development@gmail.com) or [info@apennines.com](mailto:info@apennines.com). Website: [www.apennines-khsi.com](http://www.apennines-khsi.com).